

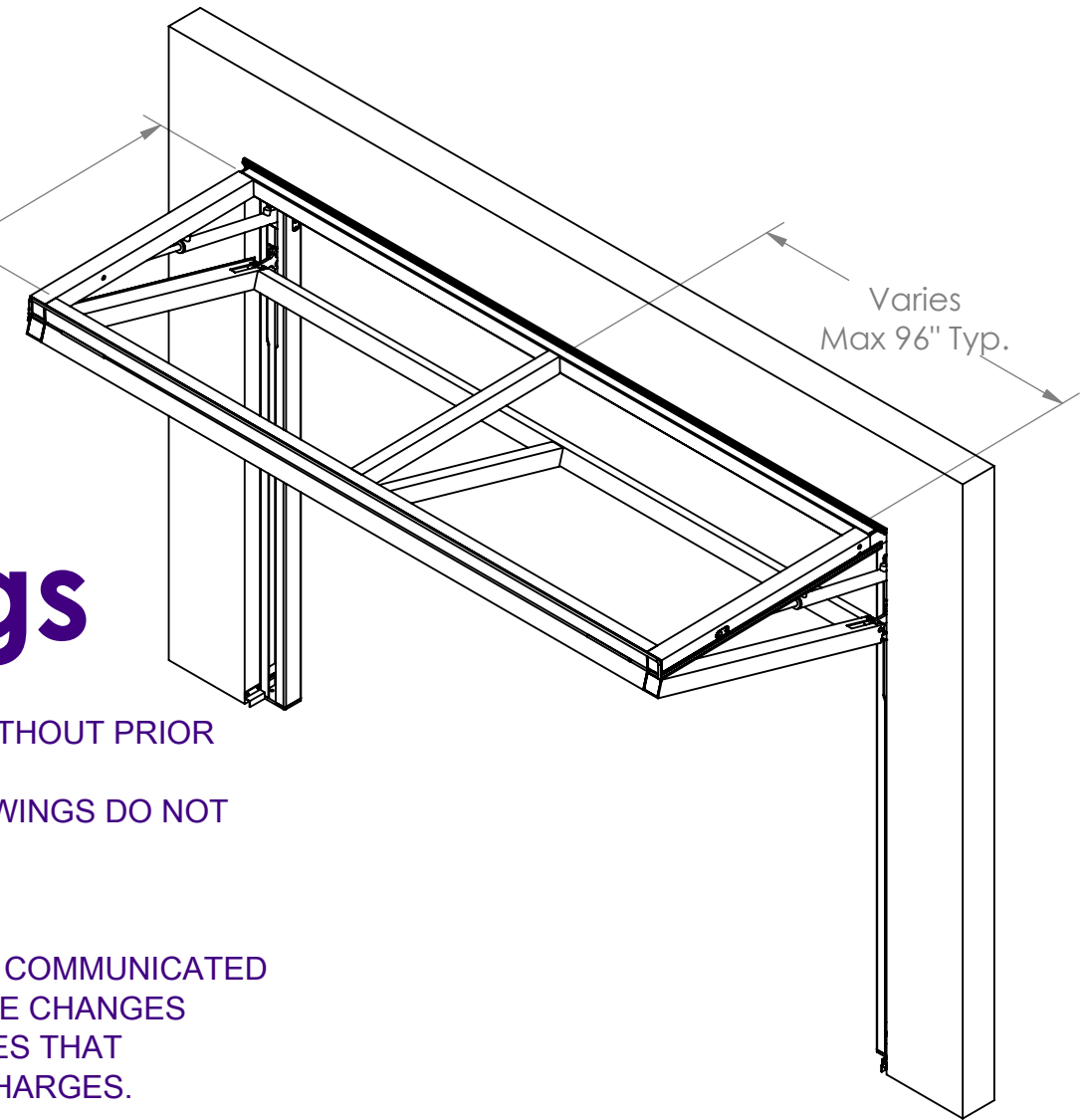

# HydAway Hydraulic Bifold Generic Sample Detail Drawings

Varies  
Max 48" Typ.

Varies  
Max 96" Typ.



**GENERAL NOTES FOR ALL SHEETS:**

1. HYDAWAY HYDRAULIC WALLS RESERVES THE RIGHT TO MAKE PRODUCT DESIGN AND INSTALLATION CHANGES WITHOUT PRIOR NOTICE.
2. THESE DRAWINGS REPRESENT TYPICAL ASSUMED CONDITIONS. PROJECT-SPECIFIC CONDITIONS MAY VARY. DRAWINGS DO NOT REPRESENT ALL AVAILABLE OPTIONS AND PROJECT CONDITIONS.
3. BUILDING JAMBS AND HEADER ARE BY OTHERS.
4. HYDAWAY HYDRAULIC WALLS WILL NOT BE HELD RESPONSIBLE FOR CODE VIOLATIONS.
5. DIMENSIONS SPECIFIED ARE CRITICAL TO PROPER PRODUCT FUNCTIONALITY. ANY REQUIRED CHANGES MUST BE COMMUNICATED IMMEDIATELY TO HYDAWAY HYDRAULIC WALLS. HYDAWAY HYDRAULIC WALLS IS NOT OBLIGATED TO ACCOMODATE CHANGES TO HYDAWAY HYDRAULIC WALLS PRODUCTS REQUIRED BY PROJECT-SPECIFIC CONDITIONS. ANY DESIGN CHANGES THAT HYDAWAY HYDRAULIC WALLS MAKES TO ACCOODATE PROJECT-SPECIFIC CONDITIONS WILL INCUR ADDITIONAL CHARGES.
6. TOLERANCE FOR VERTICAL AND HORIZONTAL STEEL MEMBER LOCATIONS IN THE DOOR LEAF IS 1/8".
7. STEEL TUBE MEMBERS INCLUDED IN THE HYDAWAY HYDRAULIC WALL SYSTEM ARE SUBJECT TO CHANGE BASED ON OVERALL SIZE, CLADDING WEIGHT, WIND REQUIREMENTS, AND OTHER FACTORS.
8. MAXIMUM BUILDING HEADER DEFLECTION UNDER LOAD IS 1/2"
9. MAXIMUM LATERAL DRIFT OF SURROUNDING BUILDING STRUCTURE IS 1/2".
10. MAXIMUM ALLOWABLE RISE OF FINISHED FLOOR BETWEEN JAMBS IS 1/2".
11. IT IS THE RESPONSIBILITY OF THE CUSTOMER/CONTRACTOR TO ENSURE THE BUILDING STRUCTURE IS ADEQUATE FOR LOADS IMPOSED BY THE HYDAWAY HYDRAULIC WALLS SYSTEM ONTO THE SURROUNDING BUILDING STRUCTURE.
12. PROJECT-SPECIFIC LOADS IMPOSED BY THE HYDAWAY HYDRAULIC WALLS SYSTEM ON THE SURROUNDING BUILDING STRUCTURE ARE AVAILABLE UPON REQUEST.
13. ALL JOINTS BETWEEN HYDAWAY HYDRAULIC WALLS SYSTEM AND SURROUNDING BUILDING STRUCTURE TO BE CAULKED BY OTHERS.



**PROPRIETARY AND CONFIDENTIAL**  
THE INFORMATION CONTAINED IN THIS DRAWING IS THE SOLE PROPERTY OF HYDAWAY WALLS. ANY REPRODUCTION IN PART OR AS A WHOLE WITHOUT THE WRITTEN PERMISSION OF HYDAWAY WALLS IS PROHIBITED.

UNLESS OTHERWISE SPECIFIED:  
DIMENSIONS ARE IN INCHES  
TOLERANCES:  
FRACTIONAL ±  
ANGULAR: MACH ± BEND ±  
TWO PLACE DECIMAL ±  
THREE PLACE DECIMAL ±  
INTERPRET GEOMETRIC  
TOLERANCING PER: ASME Y14.5-2009

SITE ADDRESS:

TITLE:

HydAway Bifold  
Generic Drawings

DOOR TYPE:

HydAway Bifold

SCALE: 1:32

SHEET 1 OF 4

REV

DATE

A

2/29/2024

4

3

2

1

B

B

Representative of Building Opening (By Others)

Representative of Building Opening (By Others)

Framed Height

Framed Width

Final Clear Height = Framed Height minus 24" (+/- 1")

Final Clear Width = Framed Width minus 12"

A

A



**PROPRIETARY AND CONFIDENTIAL**  
THE INFORMATION CONTAINED IN THIS DRAWING IS THE SOLE PROPERTY OF HYDAWAY WALLS. ANY REPRODUCTION IN PART OR AS A WHOLE WITHOUT THE WRITTEN PERMISSION OF HYDAWAY WALLS IS PROHIBITED.

UNLESS OTHERWISE SPECIFIED:  
DIMENSIONS ARE IN INCHES  
TOLERANCES:  
FRACTIONAL ±  
ANGULAR: MACH ± BEND ±  
TWO PLACE DECIMAL ±  
THREE PLACE DECIMAL ±  
INTERPRET GEOMETRIC TOLERANCING PER: ASME Y14.5-2009

SITE ADDRESS:

TITLE:  
HydAway Bifold  
Generic Drawings

REV	DATE
A	2/29/2024

DOOR TYPE:  
HydAway Bifold

SCALE: 1:30 SHEET 2 OF 4

4

3

2

1

4

3

2

1

Rubber Bulb Seal  
Trim Lok DDA2518

Removable Top  
Trim Sealing Plate

Top Leaf Side Seal  
(Pemko 319)

Silicone Adhesive Weather Seal  
Full Header Width  
(Hager 726)

DETAIL A: Head  
SCALE 1 : 3

Side Seals  
(Pemko 319)

DETAIL F: Jamb  
SCALE 1 : 8

Side Seals  
(Pemko 319)

DETAIL E: Jamb  
SCALE 1 : 8

Varies Per Project  
Requirements

E: Jamb

F: Jamb

SECTION D-D

Varies Per  
Door Height  
Approx. 45% of  
Door Height Typical

24" (+/- 1")

Hydraulic Power Unit  
Size and Position May Vary  
Per Project Requirements

A: Head

D

D

B: Middle Joint

C: Sill

72" Typical  
Floor to Controls

Trim-Lok 202 Series  
D-Shaped Rubber  
Seal (or similar)

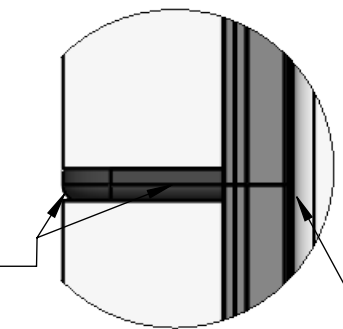

DETAIL B: Middle Joint  
SCALE 1 : 3

Barrel Hinges

Bottom Leaf Side Seal  
(Pemko 319)

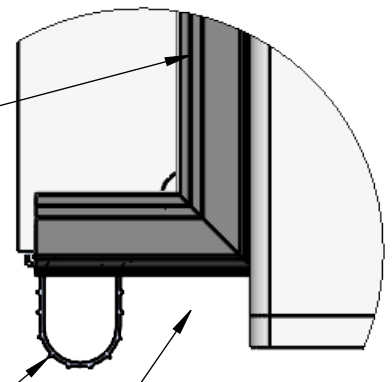

DETAIL C: Sill  
SCALE 1 : 3

Garage Door-  
Style Seal

Aluminum Z-Channel  
Not Shown This View  
See Sheet 3



**PROPRIETARY AND CONFIDENTIAL**  
THE INFORMATION CONTAINED IN THIS  
DRAWING IS THE SOLE PROPERTY OF  
HYDAWAY WALLS. ANY REPRODUCTION IN  
PART OR AS A WHOLE WITHOUT THE  
WRITTEN PERMISSION OF HYDAWAY WALLS  
IS PROHIBITED.

UNLESS OTHERWISE SPECIFIED:  
DIMENSIONS ARE IN INCHES  
TOLERANCES:  
FRACTIONAL ±  
ANGULAR: MACH ± BEND ±  
TWO PLACE DECIMAL ±  
THREE PLACE DECIMAL ±  
INTERPRET GEOMETRIC  
TOLERANCING PER: ASME Y14.5-2009

SITE ADDRESS:

TITLE:  
HydAway Bifold  
Generic Drawings

REV	DATE
A	2/29/2024

DOOR TYPE:  
HydAway Bifold

SCALE: 1:24 SHEET 3 OF 4

4

3

2

1

B

B

A

A

4

3

2

1

B

B

A

A

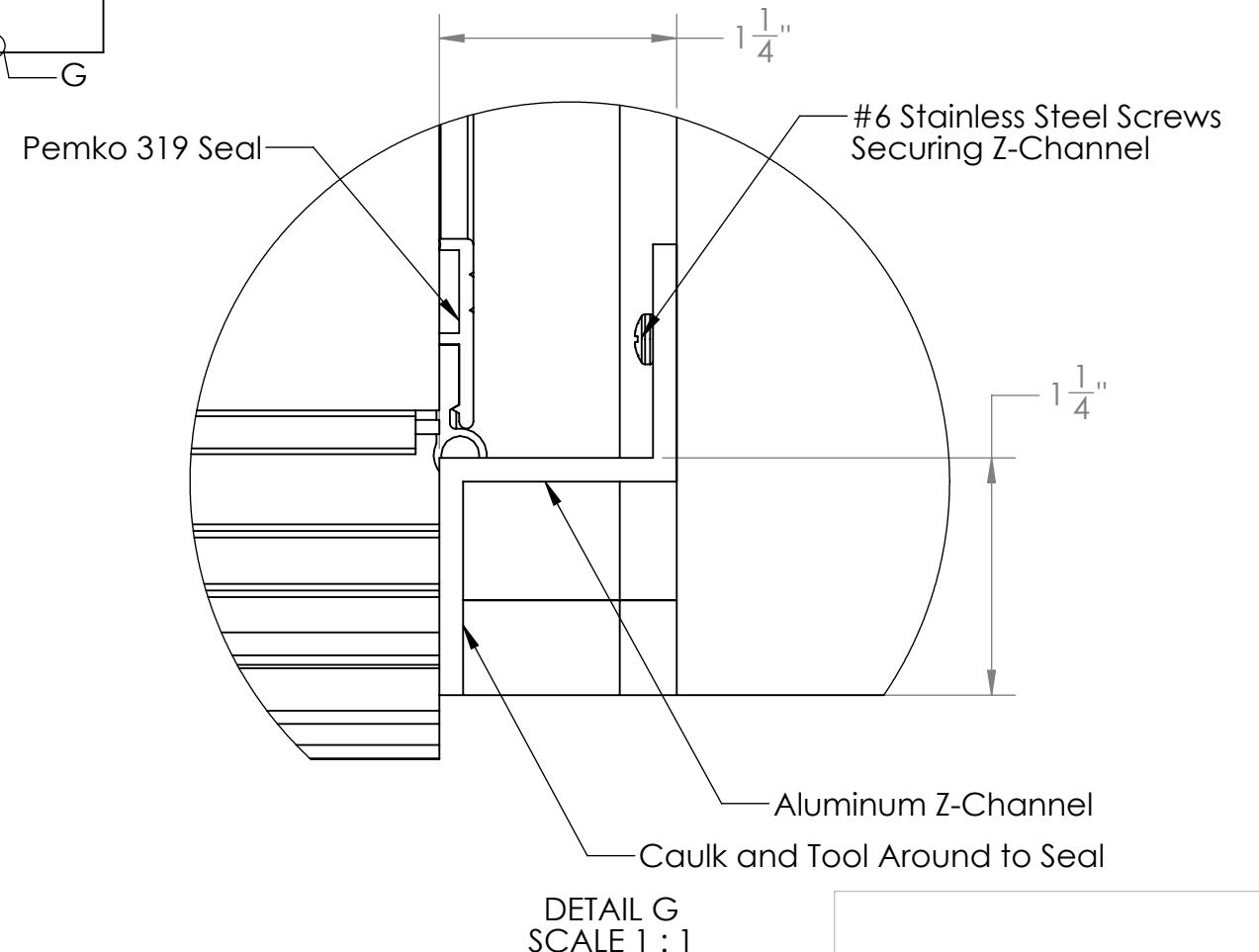
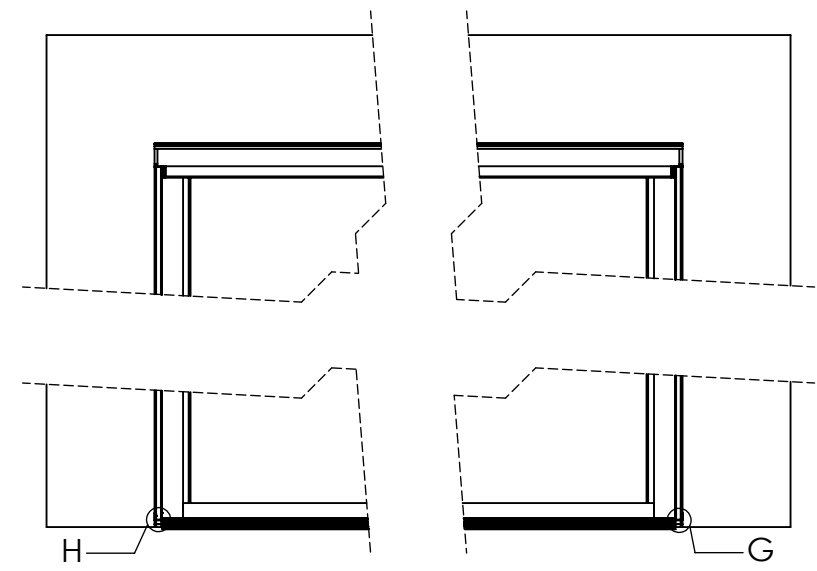
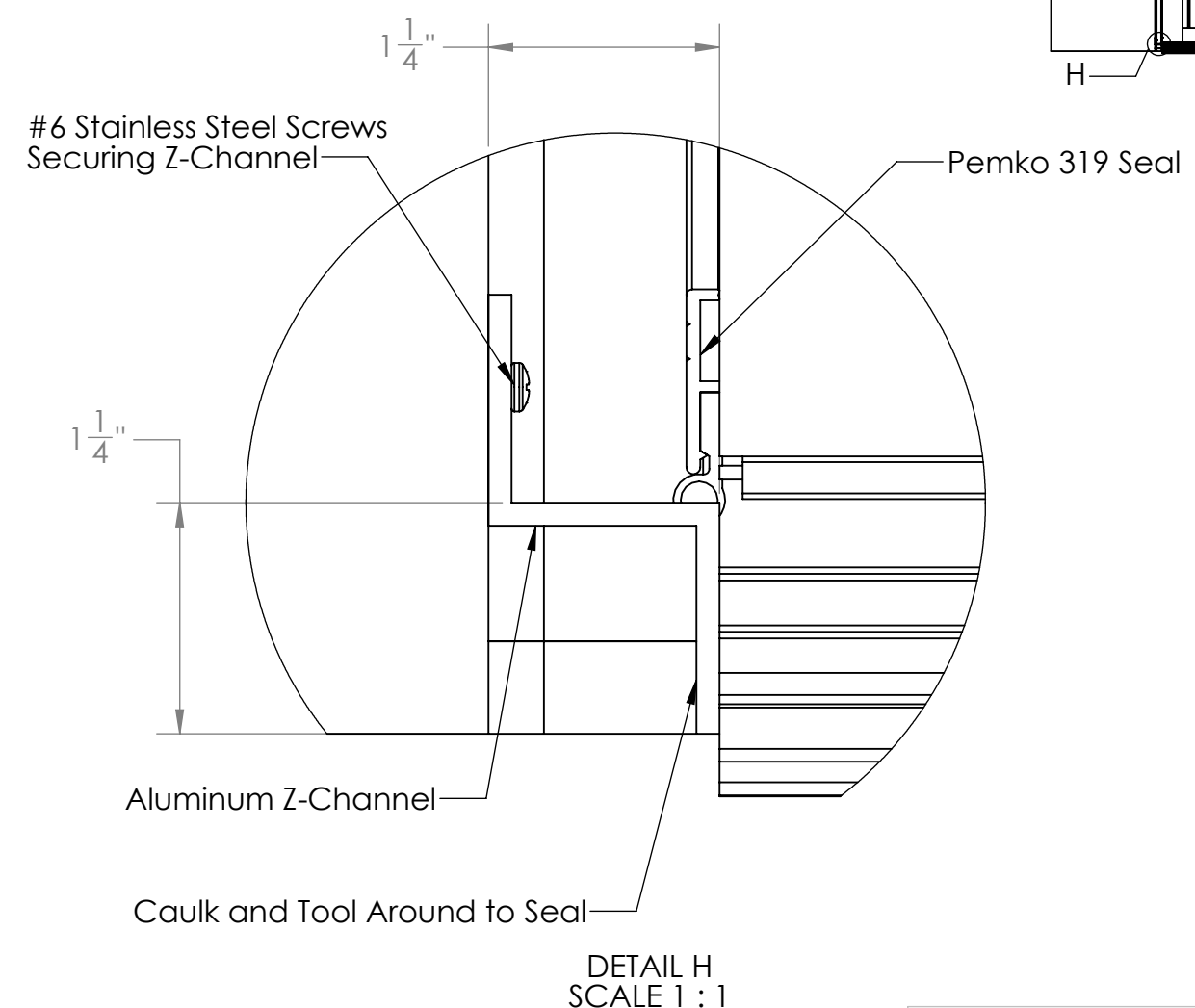

**PROPRIETARY AND CONFIDENTIAL**  
 THE INFORMATION CONTAINED IN THIS DRAWING IS THE SOLE PROPERTY OF HYDAWAY WALLS. ANY REPRODUCTION IN PART OR AS A WHOLE WITHOUT THE WRITTEN PERMISSION OF HYDAWAY WALLS IS PROHIBITED.

UNLESS OTHERWISE SPECIFIED:  
 DIMENSIONS ARE IN INCHES  
 TOLERANCES:  
 FRACTIONAL ±  
 ANGULAR: MACH ± BEND ±  
 TWO PLACE DECIMAL ±  
 THREE PLACE DECIMAL ±  
 INTERPRET GEOMETRIC  
 TOLERANCING PER: ASME Y14.5-2009

SITE ADDRESS:

TITLE: HydAway Bifold Generic Drawings		REV A	DATE 2/29/2024
DOOR TYPE: HydAway Bifold			
SCALE: 1:32	SHEET 4 OF 4		